

MINIMAX

MOBILE SERVICES



FROST-PROOF FOAM FIRE EXTINGUISHING UNIT

WS 50 sf-25 fluorine-free

PRODUCT

- ▶ Foam fire extinguishing units are ideal to fight initial fires of fire classes A and B. The extinguishing agent is a special wet extinguishing agent consisting of foaming agents and additives.
- ▶ In the case of class A fires, the extinguishing effect is based on a combination of cooling effect and barrier effect. The water lowers the temperature to below the ignition point and, as it vaporises, a molten layer is formed, which makes re-ignition impossible. The high wetting effect allows the extinguishing agent to penetrate the burning material.
- ▶ In the case of class B fires, a sliding film and a layer of foam block the supply of oxygen; re-ignition and the rise of combustible vapours are prevented.

APPLICATION

- ▶ Foam fire extinguishing units are used wherever fires involving solid, organic substances or liquid or liquifiable solids need to be extinguished.
- ▶ Foam fire extinguishers are an ideal extinguishing solution if sliding, covering and extremely stable extinguishing agent is required.
- ▶ Typical areas of application are:
 - Industrial sectors (e.g. mineral oil or animal feed industry)
 - Medical practices and laboratories
 - Shipping
 - Agriculture
 - Waste utilisation and disposal
 - Warehouses

YOUR ADVANTAGES

- ▶ Good extinguishing effect due to the combination of several extinguishing effects
- ▶ Extinguishing agent suitable for areas at risk of frost (down to -25 °C)
- ▶ Extinguishing agent contains no PFAS additives and is readily biodegradable
- ▶ Foam-water mixture with particularly effective additives
- ▶ Fast extinguishing agent availability and economical to use
- ▶ High throw range
- ▶ Re-ignition of liquid fires is ruled out
- ▶ No visibility-obstructing extinguishing agent cloud
- ▶ Low, easily removable extinguishing agent residue
- ▶ Simple operation
- ▶ Handy and maneuverable
- ▶ Good dosing capability thanks to extinguishing agent jet that can be shut off at any time
- ▶ High operational safety
- ▶ Easy to maintain
- ▶ Extinguishing agent tank made of stainless steel



FUNCTION

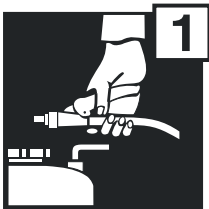

1

Lay out the hose without kinks.



2

Pull out the locking pin.
Open the cylinder valve fully.

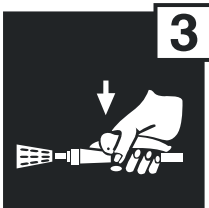

3

Point the extinguishing gun at the source of the fire and operate.

- ▶ When the cylinder valve is opened, the propellant gas flows through the pressure reducing valve and the connecting line via the inlet valve of the gas inlet into the extinguishing agent container. When the extinguishing gun is actuated, the extinguishing liquid is discharged from the foam jet pipe with the addition of air. The extinguishing agent flow can be interrupted at any time at the extinguishing gun.
- ▶ After extinguishing, close the propellant cylinder valve and place the fire extinguisher horizontally on the handle. Then leave the extinguishing gun open until the remaining propellant gas in the system has evaporated via the extinguishing hose with foam jet pipe (forced flushing with propellant gas).
- ▶ The fire extinguisher must then be filled immediately, put back into operation and the empty propellant cylinder replaced with a full one.



MAINTENANCE

- ▶ Fire extinguishers must be maintained regularly by competent persons. The intervals for maintenance of portable fire extinguishers should be done in accordance with the national regulations. The competent person has also to comply the maintenance instructions of the manufacturer.
- ▶ Suitable for up to 1,000 Volt at a minimum distance of 1 m.
- ▶ Propellant gas cylinder: capacity 3 l, filling pressure 150 bar, approved in accordance with Directive 2010/35/EU (TPED).
- ▶ Pressure vessel: approved in accordance with Pressure Equipment Directive 2014/68/EU
based on

DIN EN 1866

TECHNICAL DATA

Type	Extinguishing agent quantity, liters	Extinguishing agent	Propellant gas	Test overpressure, bar	Operating pressure (max. PS) at +60°C, approx. bar	Duration, approx. s	Foaming number, ca.	Mixture flow rate, approx./min	Foam quantity, m ³	Discharge range, approx. m	Temperature function range °C	Performance classes* A B	Weight, approx. kg	Hose version
WS 50 sf-25 fluorine-free	50	frost-proof AB-Premix -25	Nitrogen	23	7	215	8	14	0,4	7	-25 to +60	✓ B	90	Dimensionally stable, 10 m
Dimensions (W x H x D): approx. 485 x 1.097 x 630 mm													Subject to technical modifications	



Follow Minimax Mobile Services on
[LinkedIn](#), [Facebook](#), [Instagram](#), and
[YouTube](#).

Minimax Mobile Services GmbH
Export Department
Minimaxstraße 1
D-72574 Bad Urach
Tel.: +49 (0)7125 154-216
Fax: +49 (0)7125 154-166
E-Mail: exportmobile@minimax.de
www.minimax-mobile.com

