

# MINIMAX

## MOBILE SERVICES



## FOAM TUBE FIRE EXTINGUISHERS

WX 6 nG green+ and WX 9 nG green+

### PRODUCT

- ▶ Foam fire extinguishers with a separate tube permanently attached to the fitting based on an AFFF solution are ideal to fight initial fires of class A and B.
- ▶ In a class A fire, the AFFF solution extinguishes by using a combination of the cooling effect of the contained water and the strong dampening effect of the AFFF share.
- ▶ In a class B fire, the AFFF foam concentrate extinguishes by means of a separating effect, where an aqueous film blocks further oxygen supply. In addition, re-ignition and the rise of combustible vapours are prevented.

### APPLICATION

- ▶ Foam tube fire extinguishers with AFFF solutions are used wherever fires involving solid, organic substances or liquid or liquifiable solids need to be extinguished. The AFFF solution extinguishes optimally whenever thin, creeping and fast-flowing foam is required.
- ▶ Typical areas of application are:
  - warehouses, archives
  - supply rooms
  - waste recycling and removal
  - shipping
  - mineral chemistry
  - agriculture (stables, barns, silos)
  - feed industry

### YOUR ADVANTAGES

- ▶ Readable microchip with NFC technology in the fitting for clear identification of the fire extinguishers as well as automated documentation
- ▶ The extinguishant is very environmentally-friendly, it contains 0.04 % fluorine at most and are readily biodegradable
- ▶ It is maintenance-friendly, because only the AFFF solution in the tube is subject to replacement intervals, not the water in the container of the fire extinguisher
- ▶ Optimal extinguishing jet thanks to a special extinguisher nozzle
- ▶ Lever made of impact-proof high performance polymers, high corrosion resistance and sturdiness
- ▶ Easy handling due to standardised operation and immediately recognisable functions
- ▶ low weight
- ▶ Easy to proportion with an extinguishant jet that can be stopped any time
- ▶ Excellent extinguishing action through a combination of several extinguishing effects
- ▶ Plastic-coated CO<sub>2</sub> propellant gas cylinder
- ▶ Extinguishing agent container made from high quality steel: protected against corrosion by a robust polyester resin outer coating
- ▶ Standard stand pins



## FUNCTION

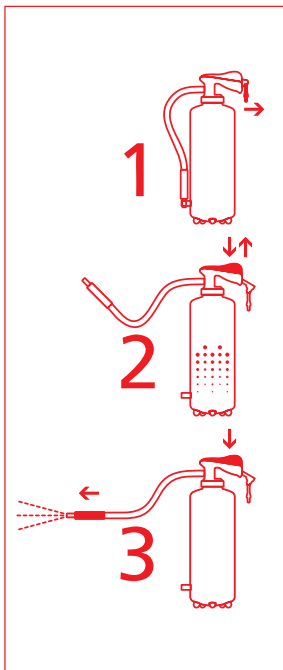

### Pull locking pin

- ▶ In the event of a fire, remove the fire extinguisher from its support and briskly pull the yellow locking pin on the handle backwards.

### Press lever, then release

- ▶ Hold the hose, press the discharge lever all the way down and release again. The fire extinguisher builds pressure through the internal CO<sub>2</sub> gas canister and can be used immediately.

### Press lever to extinguish

- ▶ Aim the extinguishing nozzle towards the fire and press the discharge lever again. Commence extinguishing in a targeted manner.

- ▶ In order to avoid operating errors, all fire extinguishers should be premises with the same operating controls. Minimax offers easy-to-use extinguishers with uniform single-lever operation for all areas of application and fire classification, thus guaranteeing high levels of safety.
- ▶ After pulling out the lock, the extinguisher is ready to operate. When the pressure lever is operated, a blade penetrates the sealing film on the propellant container and opens it. The propellant flows into the extinguishant cylinder, thus opening the burst foil, and the (AFFF) extinguishant concentrates mixes with the water. Then the propellant presses the extinguishant through the riser and the extinguishing hose and, while admixing air, pushes it out of the Extinguisher nozzle.
- ▶ The extinguishant flow is interrupted when releasing the pressure lever. Repeated operation of the pressure lever brings fires of solid substances under control. Put liquid fires out in one go!

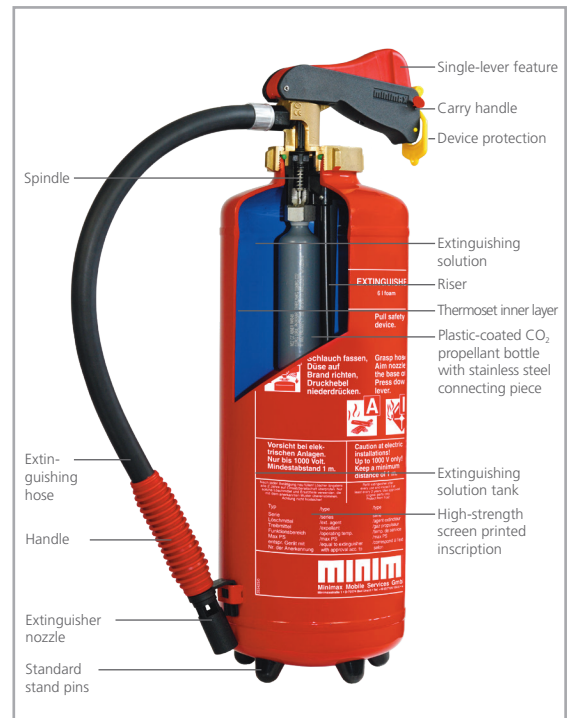

## MAINTENANCE

- ▶ Portable fire extinguishers must be maintained regularly by competent persons. The intervals for maintenance of portable fire extinguishers should be done in accordance with the national regulations. The competent person has also to comply the maintenance instructions of the manufacturer.
- ▶ After use – even after only partial emptying – extinguishers must be refilled immediately in order to reinstate operational readiness.
- ▶ All maintenance and filling tasks are to be carried out by your Minimax Service.
- ▶ Suitable for up to 1,000 Volt at a minimum distance of 1 m.

Approval

EN 3



## TECHNICAL DATA

Type	Approval no.	Design	Extinguishing agent quantity	Extinguishing agent	Propellant gas	Test pressure	Max. operating pressure (max. PS) at +60 °C	Duration	Discharge range	Temperature function range	Performance classes*	Dimensions			Weight without holder
			l			bar	approx. bar	approx. s	approx. m	°C		Height	Width	Ø	approx. kg
												mm	mm	mm	
WX 6 nG green+	SP 94/16	S6H-0	6	Water + 1 tube with AFFF concentrate	carbon dioxide	33	23	52	6	+5 to +60	21 A 183B	550	311	160	10,6
WX 9 nG green+	SP 95/16	S9H-0	9	Water + 1 tube with AFFF concentrate	carbon dioxide	33	23	87	6	+5 to +60	27 A 233B	550	320	190	14,5

\* in acc with EN 3. \*\* in acc with ASR A2.2.

Subject to technical modifications

Minimax Mobile Services GmbH & Co. KG  
 Minimaxstraße 1  
 D-72574 Bad Urach  
 Tel.: +49 (0)7125 154-0  
 Fax: +49 (0)7125 154-100  
 E-Mail: zentrale@minimax.de  
 www.minimax-mobile.com

Minimax Mobile Services GmbH & Co. KG  
 Zweigniederlassung Österreich  
 Carlberggasse 66B  
 A-1230 Wien  
 Tel.: +43 (0)1 8658161-0  
 Fax: +43 (0)1 8658161-59  
 E-Mail: mobil@minimax.at

